



PUNTI DI CHIUSURA SUPPLEMENTARE



Punti di chiusura supplementare | Extra locking pin
Pivot de fermeture supplementaire | Pernio de cierre suplementario



Perno e vite M5
TSP CR in acciaio
zincato. Art. 4246
eccentrico di chiusura
in zama, regolabile
in pressione in 8
posizioni diverse.



Pin and M5 TSP
CR screw in
galvanized steel.
Art. 4246 locking
cam in zamak, with
adjustable pressure in
8 different positions.



Pivot et vis M5 TSP
CR en acier zingué.
Art. 4246 came de
fermeture en zamak,
réglable en pression
avec 8 positions
différentes.



Pernio y tornillo M5
TSP CR de acero
galvanizado. Art. 4246
excéntrica de cierre
de zamak, regulable
a presión en 8
posiciones diferentes.



ART.	4241 4241.1 4242 4207.1 4207.2 4207.11 4246	4246.10 4246.11 4246.15 3520.32 4207.21 3421.32	3400F.32
Imballo Package Conditionnement Embalaje	50 Pz		25 Pz
Finiture disponibili Available finishes Finitions disponibles Acabados disponibles	1 2 3 4	1 2 3 4	1 2 3 4

1 424X

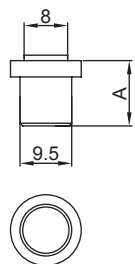

ART.	A
4241	9
4241.1	10.5
4242	12

2 4246

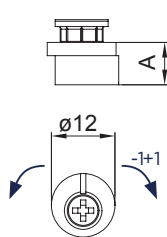

ART.	A
4246	8

3 4246.1

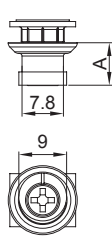

Abbinabile con la
cremonese art. 6010.12
Compatible with
cremone-bolt art. 6010.12

ART.	A
4246	8

4 4248.1

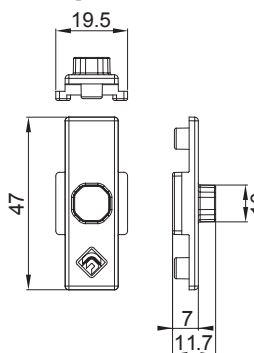

ART.	NODO SECTION
4248.11	A01 - A02 - A03 A05 - A06 - B01 - B03

5 4248.1X

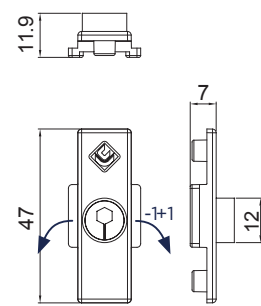

ART.	NODO SECTION
4248.11	A01 - A02 - A03 A05 - A06 - B01 - B03
4248.12	A08 - B04

6 4207.2

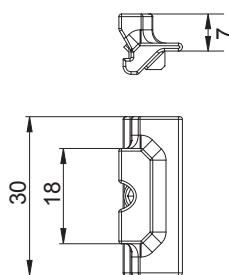

ART.	NODO SECTION
4207.2	A08 - B04

7 4207.1

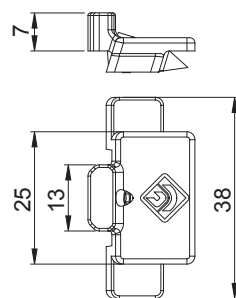

ART.	NODO SECTION
4207.1	A01 - A02 - A03 A05 - A06 - B01 - B03

8 4207.4

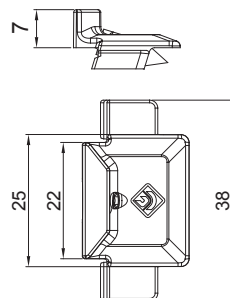

ART.	NODO SECTION
4207.4	A01 - A02 - A03 - A05 - A06 - B01 - B03

9 4207.11

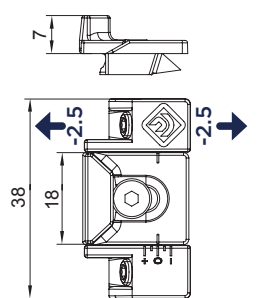

ART.	NODO SECTION
4207.11	A01 - A02 A03 - A05 - A06 - B01 - B03

6 + 5

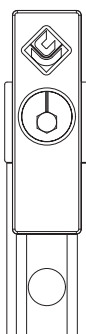
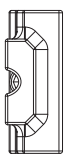

ART.	NODO SECTION
3421.32	A08 - B04

6 + 2

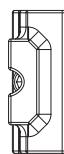

ART.	NODO SECTION
4246.10	A08 - B04

7 + 5

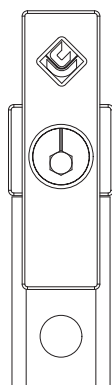
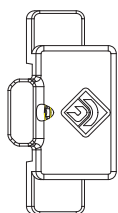

ART.	NODO SECTION
3520.32	A01 - A02 A03 - A05 - A06 - B01 - B03

7 + 2

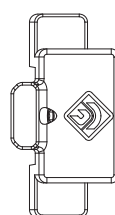

ART.	NODO SECTION
4246.11	A01 - A02 A03 - A05 - A06 - B01 - B03

8 + 2

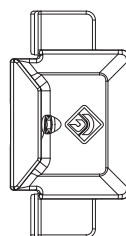

ART.	NODO SECTION
4246.15	A01 - A02 A03 - A05 - A06 - B01 - B03

8 + 5

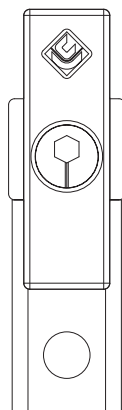
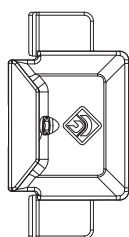

ART.	NODO SECTION
4207.21	A01 - A02 A03 - A05 - A06 - B01 - B03

9 + 4

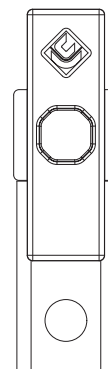
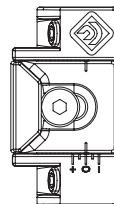

ART.	NODO SECTION
3400F.32	A01 - A02 A03 - A05 - A06 - B01 - B03